



**Sher-e-Kashmir University of Agricultural
Sciences and Technology of Jammu-180009 (J&K)**

*Dr. J.P. Singh
Professor/ Major Advisor*

No. AU/FMPE/23-24/F-SDF/167-151
Dated: 21.07.2023

QUOTATION

On behalf of SKUAST-J sealed quotations are invited through registered/speed post from reputed firms for the fabrication of a functional proto type of an **Engine Operated Maize Planter** as per the design and specifications enclosed and as per below mentioned terms and conditions.

Terms & Conditions:

- The quotations should reach the office of the undersigned through registered/speed post by 11/08/2023 up to 5.0 pm on the address **Dr. J.P. Singh, Professor & PI (URF Project), Division of Farm Machinery and Power Engineering, Faculty of Agricultural Engineering, Block No.-7(Ground Floor), SKUAST-J, Chatha, Jammu.**
- The rate should be inclusive of GST or any other taxes applicable and F.O.R. SKUAST-J, Chatha, Jammu, J&K-180009.
- The firm should have a valid PAN and GST number.
- The conditional quotations will not be accepted.
- The quotation shall be opened on the next working day after the last day and any manufacturer/firm or his representative who wish can be present at the time of opening of the quotations.

Dr. J.P. Singh
Professor, FMPE
Faculty of FoAE, Chatha,

Copy to

- Director Research, SKUAST-J, for four of kind information.
- Dean, FoAE, SKUAST-J, Chatha, for favour of kind information.
- Head, Division of Farm Machinery and Power Engineering, FoAE, Chatha, favour of kind information.
- ✓ Incharge, Data Centre, SKUAST-J, Chatha, for favour of kind information and uploading the same on University website.
- Account Officer (HQ), SKUAST-J, for favour of kind information.

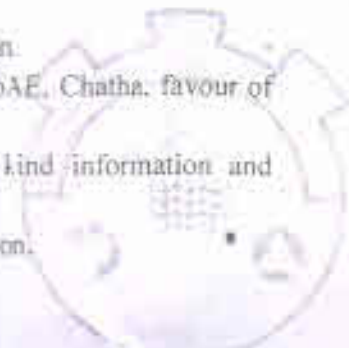

Drawing of Engine Operated Maize Planter

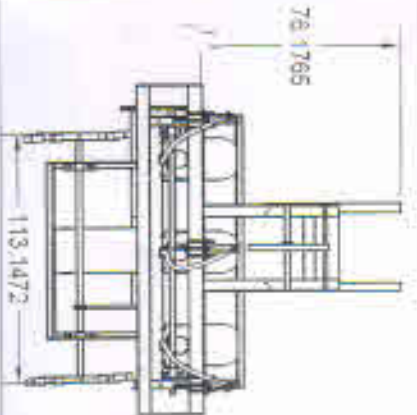
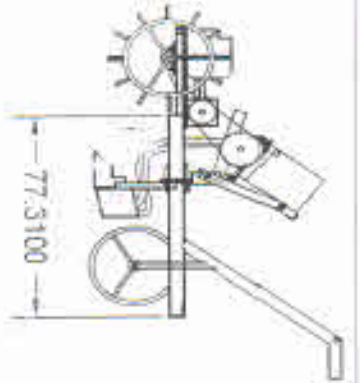

Note - All dimensions in cm

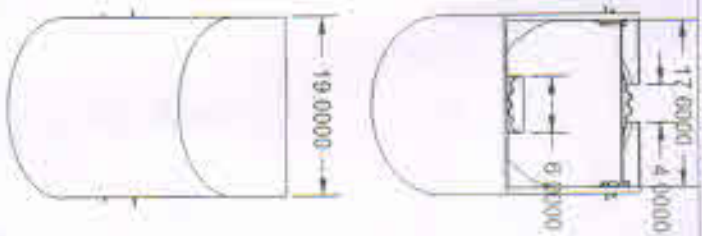
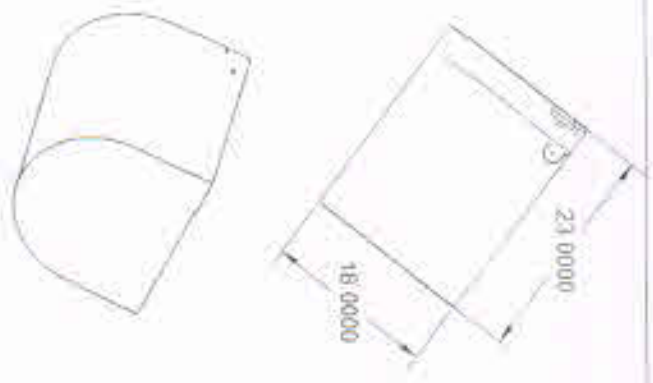

Seed metering hopper

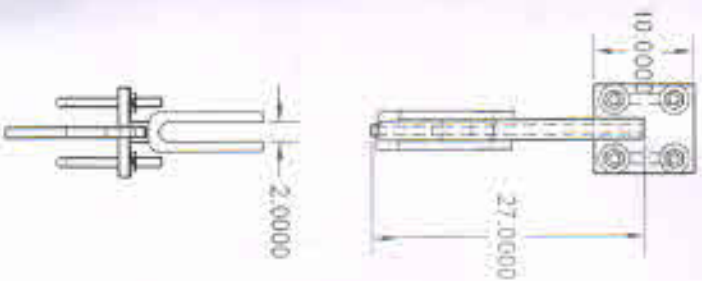
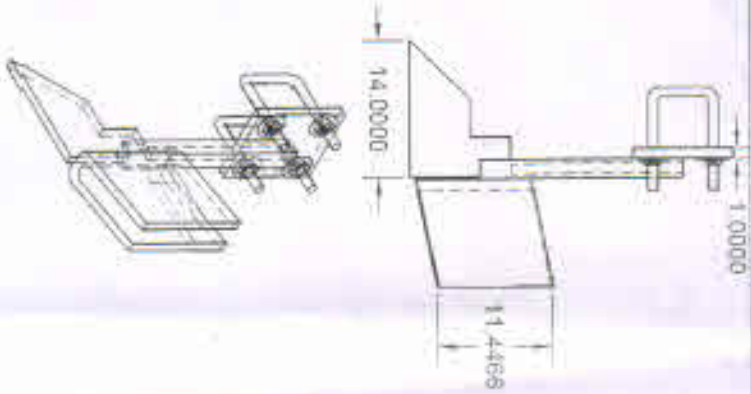

Furrow opener

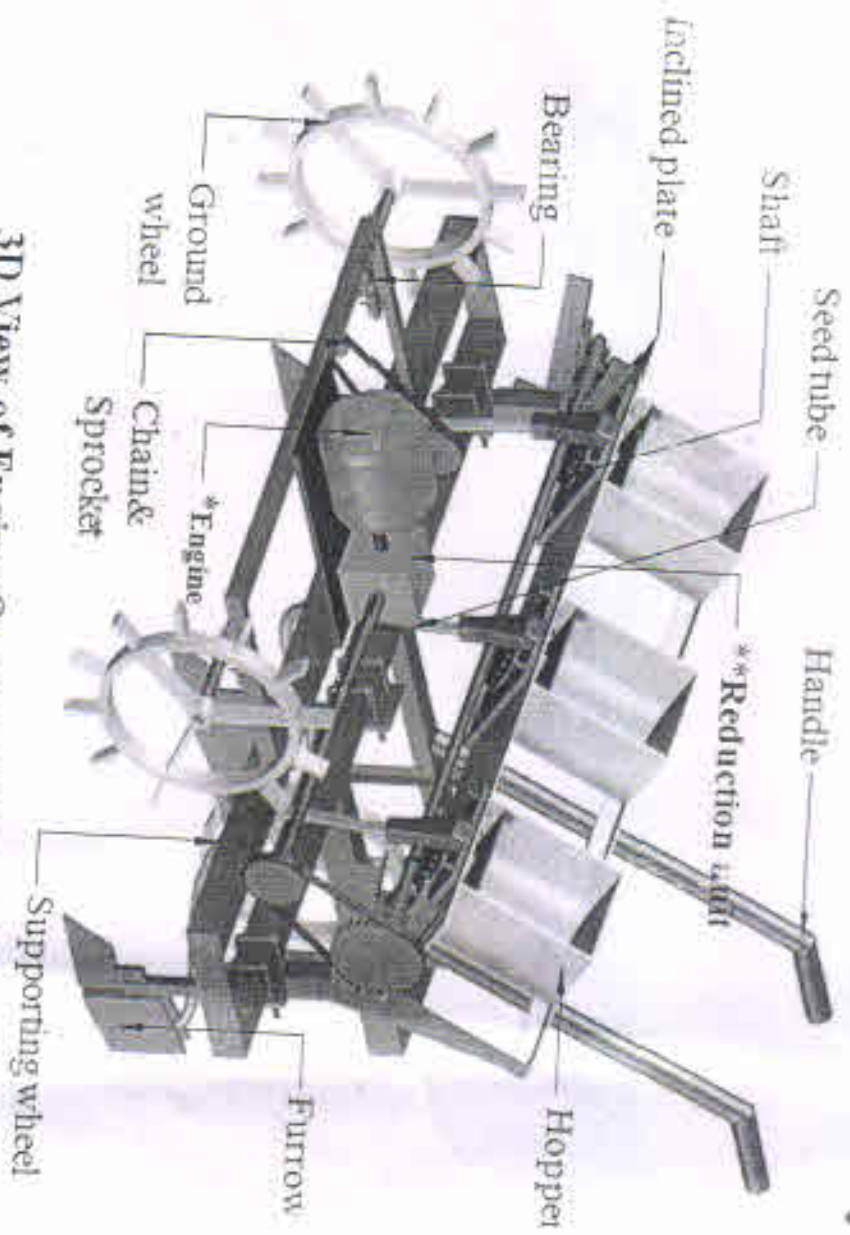

3D View of Engine Operated Maize Planter

Note:-
 *Engine (3-4 hp Diesel/Petrol)
 **Gear Reduction Unit (60:1/50:1)